

THE ASHTON WITH FLEX ROOM



Main Level Floor Plan

The Main level of The Ryan features a spacious great room with inclusive dining area open to a kitchen that supports a busy yet casual family. A large walk-in pantry compliments a well designed kitchen.

944 Finished Square Feet

Living Room: 12' x 21'

Dining Room: 9' x 13'

Flex Room: 9'8" x 14'

Kitchen: 9' x 9'

Deck: 5' x 22'



Upper Level Floor Plan

Three bedrooms including a large Master Bedroom and Bath suite create comfortable living for the entire family.

748 Finished Square Feet

Master Bedroom: 12' x 12'

Bedroom 2: 11' x 12'

Bedroom 3: 10' x 10'

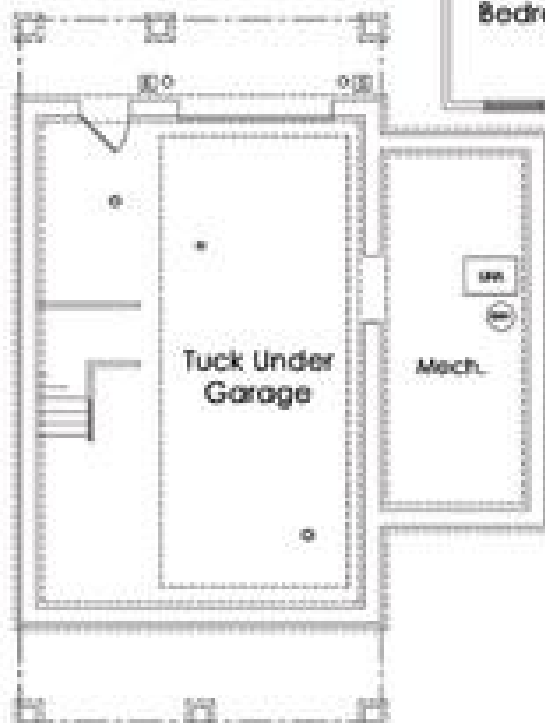

Basement Level Floor Plan

926 Unfinished Square Feet

Tuck Under Garage: 13' x 36'

Mechanical Room: 9' x 22'

Builder reserves the right to alter materials, specifications, features, designs, and prices without prior notice. Floorplan may vary according to elevation or home placement. Room dimensions and square footages are approximate and may vary. Builder reserves the right to make changes to the plan at any time. Actual plan may vary based on lot shape and size.